

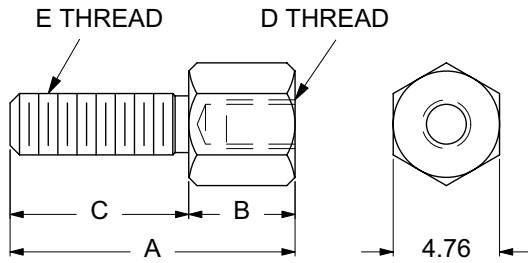

# 4.76/5mm HEX FEMALE SCREW LOCKS (metric)

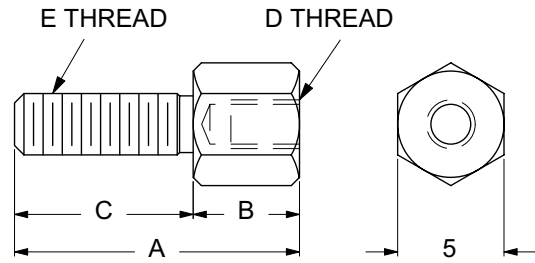

**STYLE 1**



**STYLE 2**

|                  |          |                      |        |
|------------------|----------|----------------------|--------|
| ORDERING<br>CODE | XX       | XXXX                 | XX     |
|                  | MATERIAL | BASIC PART<br>NUMBER | FINISH |

|          |      |
|----------|------|
| MATERIAL | CODE |
| STEEL    | ST   |

**STYLE 1**

| BOTH MALE & FEMALE THREADS = M3 X 0.5 |                 |          |          |                 |               |
|---------------------------------------|-----------------|----------|----------|-----------------|---------------|
| BASIC PART NO.                        | A (REF.) LENGTH | B LENGTH | C LENGTH | D FEMALE THREAD | E MALE THREAD |
| 9460                                  | 9.52            | 4.76     | 4.76     | M3X0.5          | M3X0.5        |
| 9461                                  | 11.11           |          | 6.35     |                 |               |
| 9462                                  | 12.70           |          | 7.94     |                 |               |
| 9463                                  | 14.29           |          | 9.52     |                 |               |
| 9464                                  | 15.87           |          | 11.11    |                 |               |
| 9465                                  | 17.46           |          | 12.70    |                 |               |
| 9466                                  | 19.05           |          | 14.29    |                 |               |
| 9467                                  | 20.63           |          | 15.87    |                 |               |
| 9468                                  | 22.22           |          | 17.46    |                 |               |
| 9469                                  | 23.81           |          | 19.05    |                 |               |

**STYLE 2**

| FEMALE THREADS M3 X 0.5 — MALE THREADS 4-40 UNC-2A |                 |          |              |                 |               |
|--|-----------------|----------|--------------|-----------------|---------------|
| BASIC PART NO.                                     | A (REF.) LENGTH | B LENGTH | C LENGTH     | D FEMALE THREAD | E MALE THREAD |
| 9470   | 9.52 (.375)     | 5mm      | 4.76 (.187)  | M3X0.5          | M3X0.5        |
| 9471   | 11.11 (.437)    |          | 6.35 (.250)  |                 |               |
| 9472   | 12.70 (.500)    |          | 7.94 (.312)  |                 |               |
| 9473   | 14.29 (.562)    |          | 9.52 (.375)  |                 |               |
| 9474   | 15.87 (.625)    |          | 11.11 (.437) |                 |               |
| 9475   | 17.46 (.688)    |          | 12.70 (.500) |                 |               |
| 9476   | 19.05 (.750)    |          | 14.29 (.562) |                 |               |
| 9477   | 20.63 (.812)    |          | 15.87 (.625) |                 |               |
| 9478   | 22.22 (.875)    |          | 17.46 (.688) |                 |               |
| 9479   | 23.81 (.937)    |          | 19.05 (.750) |                 |               |

| CODE | FINISH   |
|------|--|
| 00   | Plain—None                                       |
| 31   | Cadmium QQ-P-416, CL2—Clear Chromate             |
| 32   | Cadmium QQ-P-416, CL2, Type II—Yellow Chromate   |
| 33   | Zinc, ASTM B633, Type II, CL3—Black Chromate     |
| 34   | Zinc ASTM B633, Type III, Fe/Zn 8—Clear Chromate |
| 35   | Zinc ASTM B633, Type I, Fe/Zn 8—No Chromate      |
| 36   | Zinc ASTM B633, Type II, Fe/Zn 8—Yellow Chromate |
| 43   | Bright Tin—MIL-T-10727                           |
| 50   | Black Oxide MIL-C-13924—Steel                    |
| 61   | Nickel QQ-N-290 CL 1, Type VI KC                 |
| 63   | Ductile, Nickel—QQ-N-290                         |

**NOTES:**

- Two screw locks are required per connector.
- Other combinations of body length (B) and male length (C) are available.
- Partially threaded male ends are available.
- \*Most common material is steel with optional finish.
- A 6" lb. (female) and a 4" lb. (male) maximum assembly torque is recommended for steel screw locks.
- All dimensions are for reference only. Tolerances are to manufacturer's standards.

**G7**